

# ATTENTION!!!

## PLEASE READ THIS FIRST!

1). **If you're having this system installed by a professional** please ensure installer follows our installation instructions carefully, and verify their work before they leave to ensure everything is working properly and that there are no leaks. Call us BEFORE they leave so we may help resolve any issues. We recommend doing installation during our business hours (Mon-Fri 11am-6pm Mountain Standard Time) in case you need to reach us: **1-347-492-4014**

2). **Don't forget to remove the shrink wrapping from the filter cartridge/s** *(including cartridges inside the system, if any)* before flushing/using the system.

3). **Add-On Accessories:** If you purchased/included: Please ensure they are installed in following order directly after the cold-water valve:

**1<sup>st</sup> - Pressure Regulator** (required)  
*(Must be installed to keep warranty)*

**2<sup>nd</sup> - Leak Stopper** (required)  
*(Must be installed to keep warranty)*

**3<sup>rd</sup> - Gallon Meter** (optional)

**Also, please ensure the area around the Leak-Stopper is dry, else it will activate & shut off the water flow to the system.**

4). **The water may be cloudy for apx. 1-2 weeks;** this is a normal effect of the mineral fines being released, and will subside after the 1-2 week adaptation period. The taste of the water should improve further as well. *(Does not apply to whole house or shower filter systems).*



**Customer Support:**

Tel: 1-347-492-4014

Email: [info@PureEffectFilters.com](mailto:info@PureEffectFilters.com)

[www.PureEffectFilters.com](http://www.PureEffectFilters.com)

**Thank you and Congratulations** on your purchase of **The PureEffect™ ULTRA-UC** Advanced Water Filtration System Featuring Our: FluorSorb-MAX™ (Alumina-Free Fluoride Filter), AntiRad-Plus™ (Radiation Filter), SuperBlock™ (Wide-Range Chemical/Fine Sediment Filter), KDF55® (Heavy Metal Filter) and Natural Alkalinization Technologies.

## **INSTALLATION INSTRUCTIONS**

### **IMPORTANT! - BEFORE YOU START:**

**Failure to follow proper installation instructions voids all warranties and liabilities.**

**If your PSI is over 80 and/or has a tendency to Spike: please ensure there is a pressure regulator installed and is in proper working order before proceeding. At no time should the filter housings be subject to more than 80PSI (most common PSI range is between 40-80).**

**Excessive water pressure could cause damage to the system and water to leak out. Included Leak-Stopper and Pressure Regulator MUST be properly installed to maintain warranty.**

**Do not expose the system to direct sunlight and/or freezing or hot (over 120F) temperatures. Do not install the system where it would cause damage if leakage occurred.**

1. ☐ **Unpack** your system, remove and set aside cartridges (by unscrewing chambers) and inspect system for any transportation damage. If damage is found, please contact us right away.
2. ☐ **Find** the (2) individually wrapped **White Elbows**. Locate the words “IN” and “OUT” on the unit’s water connection ports. Screw 1 elbow into the “IN” port and the additional elbow into the “OUT” port of the filter system. (You may use the 2-Way output splitter for the output instead, if you ordered it).

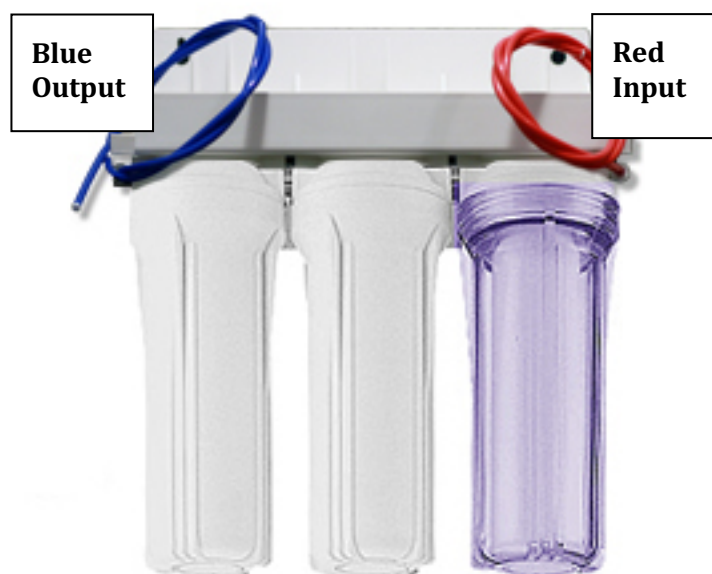

(NOTE: The Installation Diagram can be seen on page 4.)

3. ☐ **Turn-Off** the cold-water supply via your Cold Water Shut-Off Valve (**Angle Stop**) and verify it's off by opening the cold water on your faucet.
4. ☐ **Disconnect** your existing connection (e.g. **Kitchen Faucet Hose**) from the cold-water **Angle Stop**.
5. ☐ **Connect** our included John Guest® **Angle Stop Valve Adapter** to the cold-water **Angle Stop**, see example pictured below. *Note: Applying Plumbers Tape on the threading can add extra protection from leaks.*
6. ☐ **Reconnect** your **Kitchen Faucet Hose** to our John Guest® **Angle Stop Valve Adapter**
7. ☐ **Position** unit where you'd like and ensure that the blue output and red water input tubing will adequately reach the unit on the In/Out ports.

**NOTE:** If you hang the unit system under the sink, you will need to hang it at least 4" above floor (to allow for removal of chambers for cartridge changes). However, *we recommend you stand the unit on itself instead of hanging it for easier access/use.*

8. ☐ **Push-in** one end of the **Red** tube into the Quick-Connect port of the John Guest® Angle Stop Valve Adapter until it "pops-in" as far as it can go & push the other end into the INPUT port of the devices below in the listed order:

**First:** Pressure Regulator (*required*)

**Second:** Leak-Stopper (*required*)

**Third:** Gallon Meter (*optional*)

**NOTE:** Ensure to follow the flow-direction indicator arrows/wording on each device to ensure the flow is in proper direction.

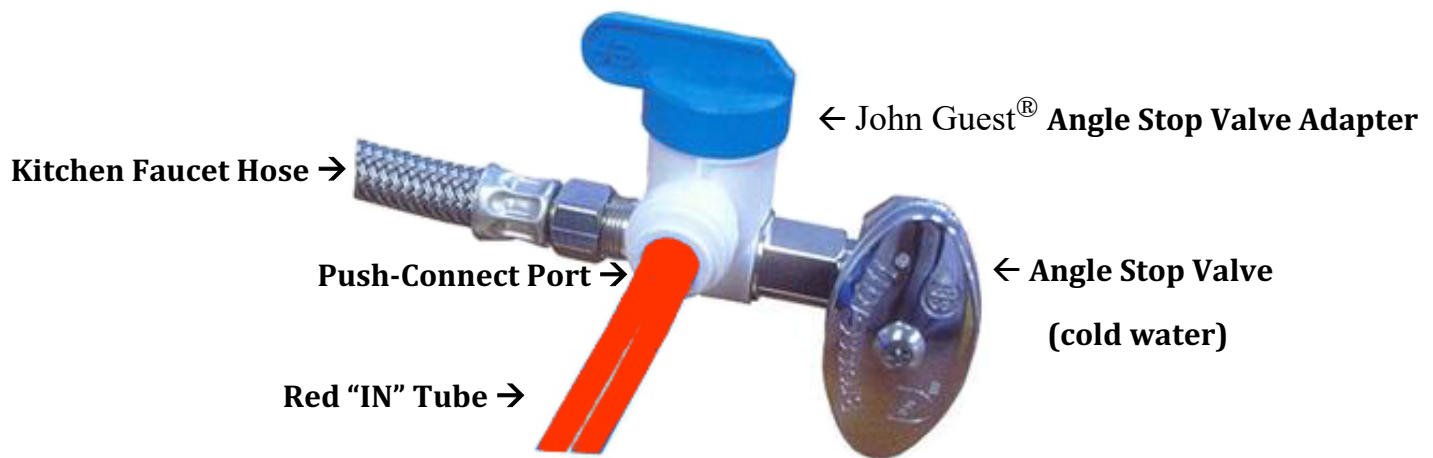

9. ☐ **Install** the dedicated faucet into the sink. (Instructions on next page).

## FAUCET INSTALLATION INSTRUCTIONS

1. ☐ Use existing spray hose / soap dispenser hole or drill a new 1-1/4" diameter hole in sink. *(If your sink is ceramic, granite or some other fragile material please consult with an expert to avoid cracking it during drilling).*

2. ☐ Connect parts 9-11 to the faucet *above the sink* as shown on diagram to the right and place faucet into the hole.

3. ☐ Connect parts 12-15 to the faucet *below the sink* as shown on diagram to the right, tighten the Locking Nut #14 with a basin wrench.

**NOTE:** Hand-Tighten part #15 to avoid damaging it with instruments; Plumbers tape can be added before screwing it on for extra leak-proofing.

4. ☐ Push the **Blue** Input Tube into Part #15 (Push-Connect Fitting) as far as it can go. This self-seals the tubing connection.

5. ☐ Push the other end of the **Blue** tube into the filter OUTPUT elbow as far as it can go.

***\*To Disconnect the tubing from any connections:***

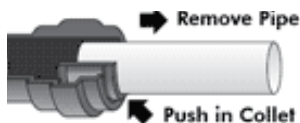

FAUCET COMPONENT DIAGRAM

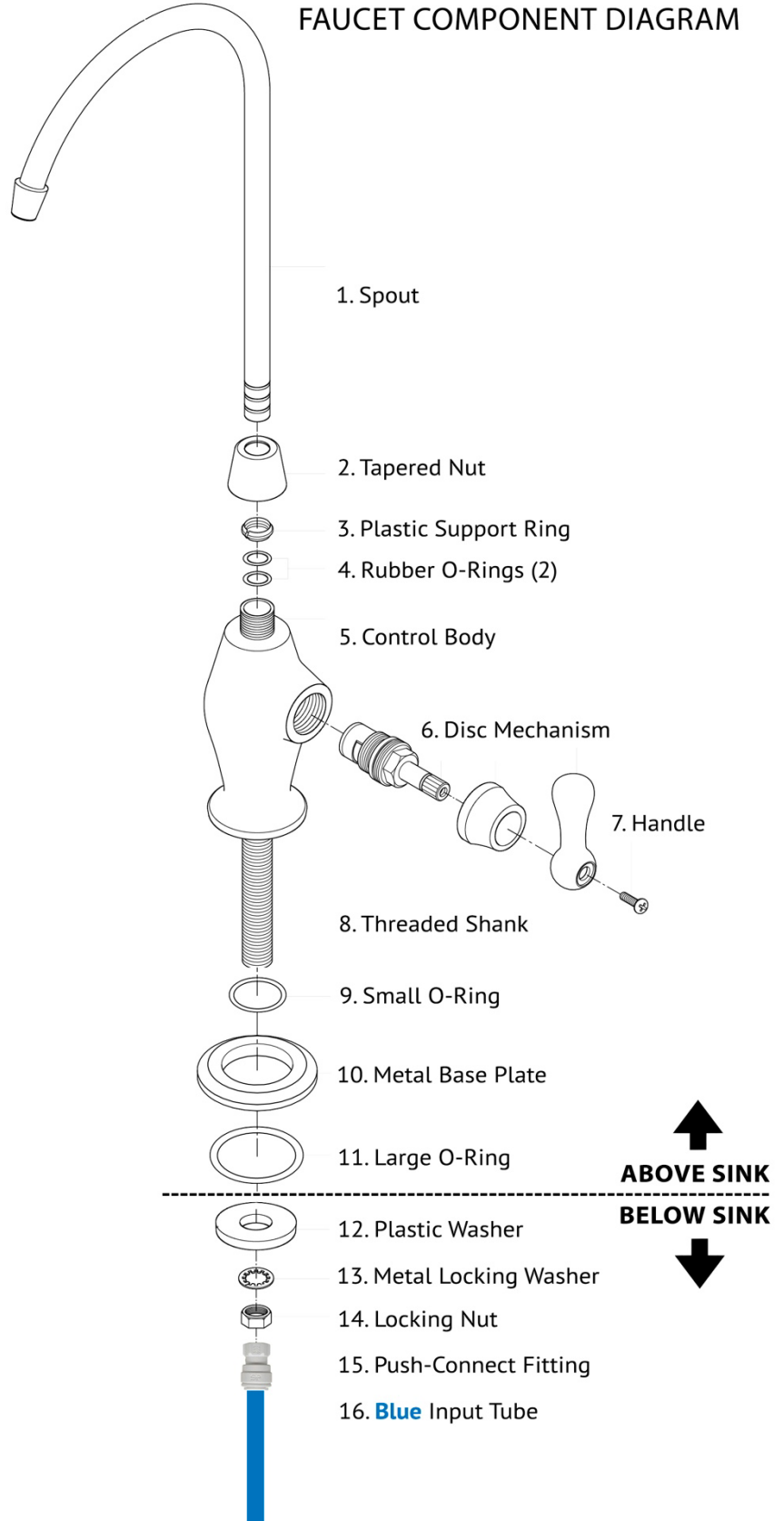

## UNDERSINK INSTALLATION DIAGRAM

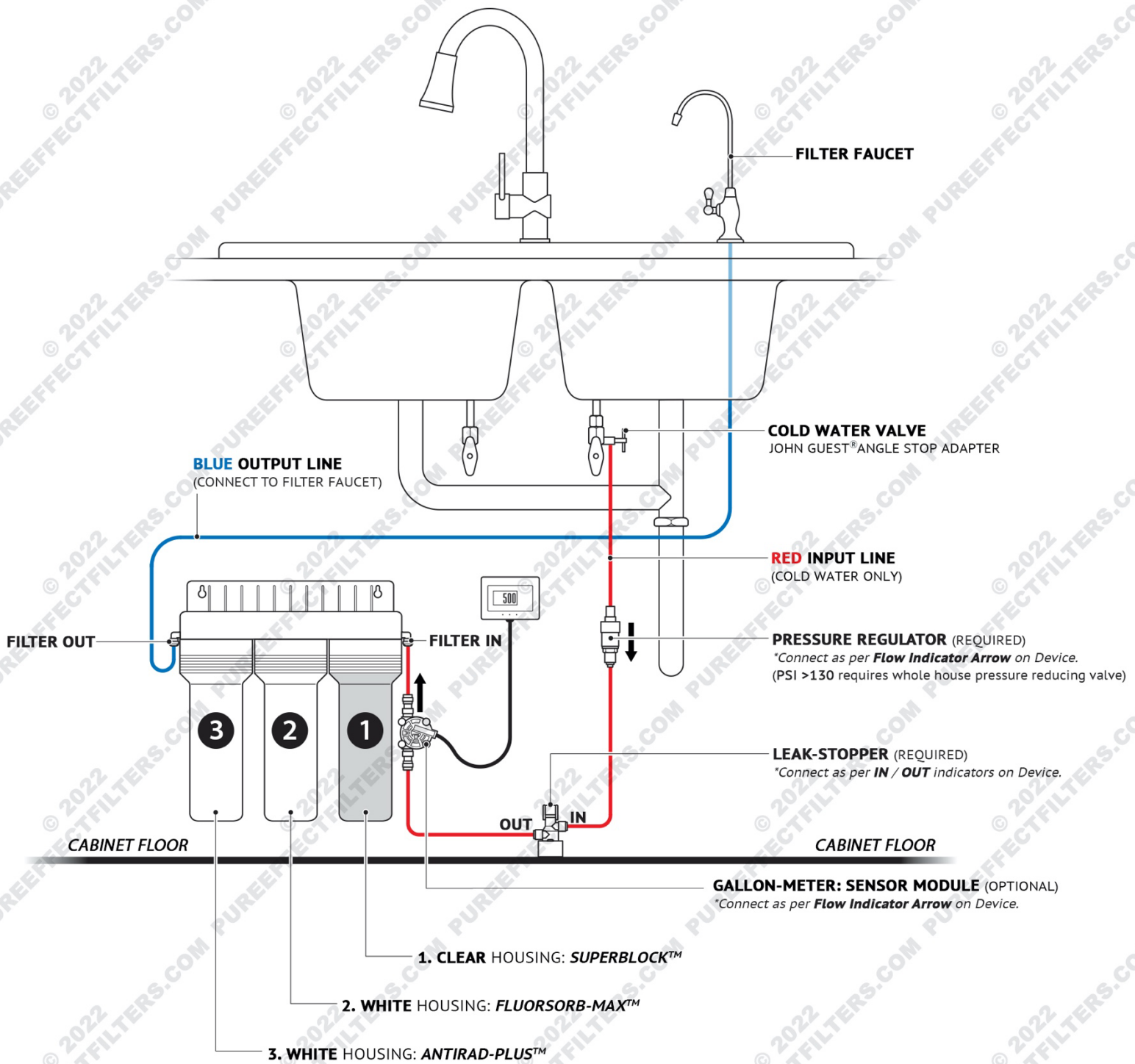

See next page for proper cartridge placement & flush procedure →

## INITIAL CARTRIDGE FLUSH AND SYSTEM LEAK TEST

**IMPORTANT! – ENSURE CARTRIDGES ARE INSERTED IN CORRECT ORDER!**

**Note:** You may want to place something under the unit to catch the water which is released when you unscrew the last chamber for Step C.

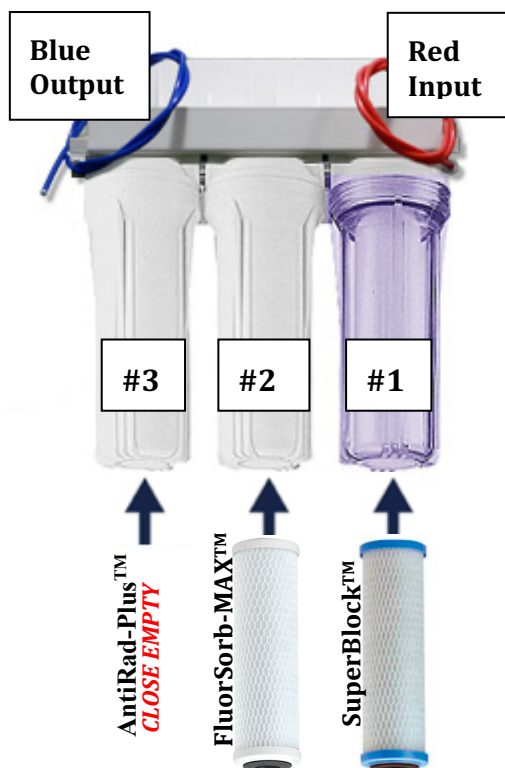

**□A. Remove Shrink Wrapping** and insert the cartridges in the following order:

**Chamber #1 - SuperBlock™**

**Chamber #2 - FluorSorb-MAX™**

**Chamber #3 - *Close Empty* for now**

**NOTE:** We recommend to hand tighten housings when closing to prevent over tightening.

**□B. Slowly turn the cold-water valve back on**, check newly installed faucet and all connections for a watertight seal. Open the filter faucet and let the water run for **5 minutes**.

**NOTE:** you may hear a slight “hissing” sound when the filter is working; this is normal. You may notice the water is cloudy; this is just mineral/carbon fines being released.

**□C. Shut off water supply to filter** then open filter's faucet to release water pressure. **Remove Shrink Wrapping** and Insert the **AntiRad-Plus™** Cartridge into **Chamber #3**. Run the water through the system again for **10 additional minutes**.

**CONGRATULATIONS! - YOUR SYSTEM IS READY FOR USE**

THE FILTER SYSTEM IS DESIGNED FOR COOL - COLD WATER USE ONLY.

**Note:** Water may be cloudy for about a week as the natural minerals in the cartridges adapt, to speed the adaptation period up, turn the system on 15-20 seconds at a time more often throughout the day. Do not flush for longer periods, as it won't be as effective as smaller bursts.

**\*\* To Disconnect the tubing from any connections:**





## **FOR CARE & OPTIMAL PERFORMANCE:**

1. You may let the kitchen faucet run for a few seconds before using the filter, as this will extend the filter life by flushing out any large sediment in the pipes.
2. Flush the system for 2 minutes when it hasn't been used for 2 or more days.
3. Never run hot water through the filter, as the filtration process will not be effective. Use only cold/cool water. Throughout usage you may notice the water level fluctuate in the clear chamber, this is normal effect and does not interfere with proper filter function.
4. **IMPORTANT!** Whenever opening chambers to replace/remove cartridges, make sure to first shut off the unit's main water supply line.
5. **Filter Cartridge Replacement** (Every 500gal. for consistently superior water quality) \*:

**a. Every 6 months:** If using up to 2-3 gallons (32-48 cups)/day.

**b. Every 12 months:** If using up to 1-2 gallons (16-32 cups)/day

*\*Based upon one of the most difficult to remove contaminants (Fluoride) at the federally recommended levels of 0.7mg/L. For greater Fluoride levels, replace the Fluoride cartridge sooner:*

*a. If Fluoride Concentration: apx. 2.2ppm = Replace Every **150** gallons*

*b. If Fluoride Concentration: apx. 1.2ppm = Replace Every **300** gallons*

**We recommend** you lubricate the black rubber O-rings inside the housing and on the spout with a FDA & NSF Compliant Food-Grade Silicone lubricant (Available on our site in the "Parts" Section) once a year to help maintain leak-free performance.

*\*If there is high sediment amount in your water, your carbon block may clog sooner, resulting in a reduction in water flow. In this case, only the first cartridge SuperBlock™ (our advanced dual-catalytic carbon block) would need to be replaced sooner.*

6. **During cartridge changes:** remove cartridges and wipe the unit clean inside using non-toxic dish soap and rinse well with warm water. Dry the black rubber O-rings in housings and apply thin coat of food-grade silicone lubricant.

*\*We recommend you **HAND TIGHTEN** the housings closed, so to avoid over compressing/damaging the rubber O-rings inside, however, to open, use the provided white wrench. If you need to use the wrench to tighten the housings closed, please take extra care not to over-tighten.*

7. Do not use system if your water pressure above 130PSI without first installing a whole house pressure reducing valve set below 80PSI.
8. Replace **Pressure Regulator** and **Leak-Stopper** Devices every **4** years.

## RETURN POLICY & WARRANTY

1. If the filter arrived damaged, please call us immediately to get an exchange: 1-347-492-4014
2. If you choose to return the filter for any reason other than damage upon arrival, we will be happy to issue a full purchase price refund or exchange within: **14 days of delivery date, minus shipping cost. The return policy applies to water filter systems and any unused (sealed) filter media cartridges.** If cartridges have been opened and used, we will deduct the price of the cartridges from the refund, as they will no longer be re-sellable.
3. **If you decide to return past the 14-day return period, we will still accept the item for up to 30 days from delivery date,** however, there will be a reasonable 10% restocking fee applied. Please call us or send an email to initiate the return process or if you have any further questions.

Once you've experienced your new system, feel free to share your positive experience by going to our website product page and writing a review. ☺ Thank You! - The PureEffect Team



### **NO-HASSLE 2-YEAR WARRANTY**

*PureEffectFilters LLC. dba PureEffectFilters.com, warrants its water filter systems to be free of defects in parts and workmanship for a period of: **two (2) years** from the date of purchase.*

*All our systems are made of high-quality components (not made in china) and are designed to last for many years beyond the warranty period, but if any manufacturing defect is present, it will make itself know well within the warranty period.*

*In the rare case that it should become necessary to repair or replace the filtration system or one of its components, please take a photo of the damaged part and email it along with your order # and a detailed description of the defect to: **info@PureEffectFilters.com** or contact our Customer Service Department at: **1-888-891-4821**. We will handle your claim promptly, and as hassle-free as possible.*

*This warranty does not apply to defects resulting from action/s of the user such as: misuse, accidents, improper installation, operation outside of specification (e.g. over the indicated PSI limit, exposure to direct sunlight, freezing temps, UV light), improper maintenance or repair and unauthorized modification.*

*PureEffectFilters LLC total liability is limited solely to repair or replacement of the product. The warranty set forth above is inclusive and no other warranty, whether written or oral, is expressed or implied.*