

INSTALLATION CHECKLIST

We highly recommend: Scheduling the installation during the following hours:
(Mon-Fri, 11am-2pm Mountain Standard Time) to ensure we have time to assist.

REQUIRED TO ACTIVATE WARRANTY: Please have installer complete this checklist, email it to: art@PureEffectFilters.com and keep a copy for your records.

I, _____ (*Installers' Full Name*), of: _____
_____ (*Company*), confirm that I've completed the initialed steps below:

(Please initial next to each completed item)

____ **1. Ensured to remove shrink wrap from cartridges inside the system/housings.**

____ **2. Measured the water Pressure (PSI) to ensure it is under 80PSI.** If the pressure is 80 PSI or greater and/or has a tendency to spike, a pressure-reducing valve (set below 80PSI) was installed BEFORE the entire filter system.

____ **3. Ensured that the direction of the water flow matches** the directional indicators (e.g. In/Out Labels and/or Flow Direction Arrows) on the relevant components.

____ **4. Created a Bypass around the entire filter system,** so that in an event the filter system is out of service the customer can still get water to their home.

____ **5. If there's a fire suppression system,** connected its water supply **BEFORE** the leak-stopper device, to avoid water being shut off to it in case of fire.

____ **6. Installed the included automatic Leak-Controller / Shut-Off Valve** at the INPUT of the entire whole house filter system.

____ **7. Installed a garden hose faucet at the INPUT and OUTPUT** lines connecting to the filter system so that customer can flush cartridges/ bypass filter with garden hose.

____ **8. If Customer purchased our Descaler-MAXTM,** ensure its installed as the Last stage of filtration and that the Descaler cartridge was inserted only after flushing preceding cartridges.

____ **9. Thoroughly verified the installation to ensure there are no leaks and that the leak-stopper is functioning properly.**

Installers Signature

Installers License #

____/____/_____
Installation Date

INSTALLATION OPERATION MANUAL



Please read this manual carefully and save it for future reference.

For assistance/support, contact us at:

www.PureEffectFilters.com / 1-347-492-4014 (Mon-Fri 11am-6pm MST) / info@PureEffectFilters.com



INSTALL SYSTEM OUT OF THE ELEMENTS, DIRECT SUNLIGHT OR FREEZING TEMPERATURES.

STEP 1- Assemble Main Tank Connections

Check plumbing pressure to ensure it's **under 80PSI** and determine optimal location of the Main Tank for connecting it to the main cold-water pipe; then assemble it as per 7-Steps below: Remove cap from top of tank (pictures on p.5.), the parts box is inside.

Note: Ensure there is sufficient space for the Pre-Filter and the Descaler-MAX™ (optional) housings to the left and right side of the Main Tank (see diagram on Page 4).

IMAGE AND INSTALLATION INSTRUCTIONS

PART IDENTIFICATION	PART NUMBER
1. Filter housing	CTA0840BBBKP5-04C00
2. Bottom Inlet/Outlet cap assembly	CT-INOUTASSY
3. Vertical elbow	CT-VERTICALELBOW
4. Flow Meter Assembly	CT-CTMETERASSY
5. Bypass manifold	CT-BPMANIFOLD
6. Straight or 90-degree Angled In/Out 1" MNPT plumbing connectors	CT-1MNPTSELBOWSET
7. 3/8" PEX Drain valve assembly with shut-off	CT-38DRAINVALVEJG
8. Umbrella Cap with PCB assembly and battery backup	CT-PCBUMBRELLA
NOT SHOWN: Power Supply	CT-POWERSUPPLY

The system and installation must comply with state and local laws and regulations.

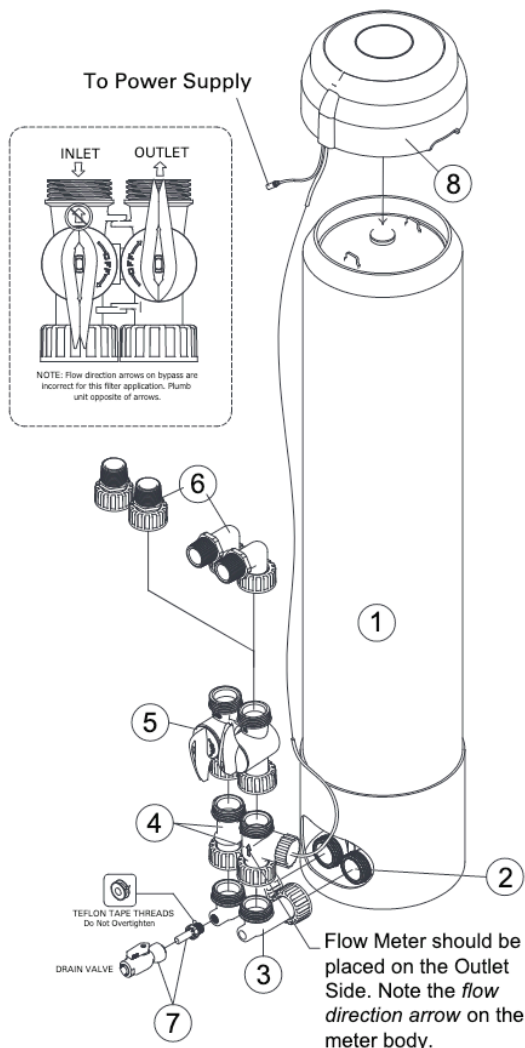

SIMPLE ASSEMBLY INSTRUCTIONS

1

Connect #3 to #2 on the bottom of the Filter Housing #1

HAND TIGHTEN ONLY

2

Connect #4 to #3; Flow Meter Assembly should be placed on the Outlet Side. (Note the flow direction arrow on the meter body.)

HAND TIGHTEN ONLY

3

Connect #5 Bypass to #4

HAND TIGHTEN ONLY

4

Use either part of #6 for connecting your plumbing to the system

HAND TIGHTEN ONLY

5

Install part #7 into #3 using the threaded connection & Teflon® tape

HAND TIGHTEN ONLY

6

Connect 3/8" PEX Plumbing to drain

NOT PROVIDED

7

Install 3-AAA batteries to #Umbrella Cap; connect to Power Supply

Plumbing the filtration system assembly: The inlet and outlet of the filtration housing are 1" Threaded MNPT connections.

****No Use of Extra lubricants, unapproved sealants, and use of tools. Use of tools other than hand tighten only parts, voids warranty.**

Please allow 3 feet of open space above the system for replacement cartridges.

System to be supplied only with cold water.

STEP 2 - Attach Brackets & Fittings. Align & Hang Housings

A). Screw the white metal brackets to the top of **Black Caps** of the **CLEAR Pre-Filter** and the **WHITE Descaler-MAX™** (if purchased) housings. *(fully assembled system image on P4.)*

Note: Use the included **Phillips Head Screws** for this. Notice the **IN/OUT** indicators on the caps before attaching bracket so as to maintain proper flow direction.

B). Apply sufficient plumbers' tape on the brass hex nipple threads and screw them into the in/out ports of the Pre-Filter and Descaler-MAX™ housings.

C). Install the **JG® Speedfit™/ProLock™** fittings (included) as per diagrams below:



D). After the fittings are installed, ensure the housings are properly positioned/aligned against the wall in relation to the Main Tank connections so that the pipes will match up properly with all fittings when connected, then hang the housings accordingly.

Note: The brackets must be screwed into sufficient wall support: e.g. into wood beam or onto an additional wood support backboard (if you need to extend the housings beyond the wall).

STEP 3 - Install Leak-Stopper

Connect the Leak-Stopper (required to maintain warranty) **BEFORE** the entire system as per its instructions.



Note: Insert the 9V backup battery into the leak-stopper control panel (by unscrewing the 4 screws). Plug it into a GFI power outlet **AFTER** installation is complete and everything is dry. Test to ensure proper operation. **If there is a Fire Suppression System:** Ensure its water supply is connected **BEFORE** the leak-stopper.

STEP 4 - Install Bypass, Connect Pipes & Pressure Gauge

Create bypass around the entire system so you can re-direct water to the home in case system ever needs to be turned off for service, etc. and connect the pipes (PEX recommended). *Required if adding Descaler) to the system. Connect Pressure Gauge as shown below. Install a drain faucet at the output of the system to bypass home plumbing when flushing new cartridges via a hose.

Note: After the pipes are connected, twist the ProLock™ rings on the relevant fittings to lock the pipes in place, you should hear/feel a click, ensuring maximum security.



STEP 5 – Install Cartridges

Install the **Pre-Filter Sediment cartridge** and the **Main Tank Cartridge** (leave the Descaler-MAX™ cartridge out for now and close that housing empty).

Note: Remove the shrink wrap from the Pre-Filter and Descaler-MAX™ Cartridges that are inside the housings.

TO INSTALL CARTRIDGE INTO MAIN TANK:



1. Push down the top cap with both hands to unseat the retaining ring, and remove the retaining ring by carefully grasping the handle and pulling inward, then upward. The retaining ring should slide completely out of the groove.
2. Remove the Top Cap from the housing assembly by pulling the cap out of the top of the tank, by lifting up on the top handles. Place removed Top Cap on a clean and dry surface, free of debris, so no contamination of the o-ring occurs.
3. Look down into the tank assembly, and you should see a small opening centered in the bottom of the tank.
4. Remove packaging from filter, then place the cartridge into the tank with the double o'ring facing down.
5. Position the cartridge so that it is aligned with the bottom, center opening.
6. Press down on the cartridge so that the double o'ring seal moves into place within the bottom, center opening.
7. Reposition the Top Cap into its original location.
8. Reattach the top tank Snap Ring, pull up on the Top Cap to seat o-rings.
9. Run water through system for 10 minutes before use.

STEP 6 – Flush System & Check for Leaks

Flush the system (bypassing the home plumbing) **for apx. 10 minutes** and **carefully check all connection points for leaks** (a flashlight can help you better target and detect leaking water).

Once the flush is complete, the system is ready for use.

Note: If you purchased the Descaler-MAX™ add-on, you may insert that cartridge into that chamber after this flush. ***If you have new copper plumbing,** leave the Descaler-MAX™ cartridge out for about 6 weeks to allow the new pipe copper leaching to clear out.

CONGRATULATIONS YOUR INSTALLATION IS COMPLETE!

MAINTENANCE

CAUTION!! BEFORE SERVICING THE UNIT: Turn off main water supply to the home first, then open the drain valve on the bottom of the main tank and a faucet on the lowest floor of your home to release water pressure. Press the Red Pressure Release buttons on top of each housing until all air escapes & main tank's fully drained before opening housing/s.

A). MAIN TANK CARTRIDGE: Replace when LED lights turn Red. When the LED lights turn Yellow we recommend you order a new cartridge set as this means you have 10% capacity remaining.

EASY TO UNDERSTAND LED REPLACEMENT NOTIFICATIONS

The Real-time Dynamic LED System monitors water and flow rate and provides a visual color-coded notification to the homeowner, letting them know when to replace their filter.



EASY FILTER REPLACEMENTS AND NO TOOLS REQUIRED

REPLACING THE CARTRIDGE

1. Turn off the water supply to the system by shutting off the inlet and outlet valves on the bypass.
2. (Optional) Install a 3/8" PEX tubing hose to the provided John Guest® fitting and shut-off that connects to the inlet side of the filtration system. Run the hose to a floor drain or bucket, and use to drain sediment or to aid in filter removal during change-out.
3. Remove Umbrella Cap on the top of the vessel. Replace the 3-AAA batteries with new batteries. Push and hold the reset button on the metered board for 3 seconds to reset the totalizer. When the totalizer is reset the LED lights will flash green 3 times to confirm that it is reset.
4. Depressurize the system by pushing down on the red depressurization button on the top cap of the system. Keep the button pushed down until all the air or water pressure is completely released.
5. Push down the top cap with both hands to unseat the retaining ring.
6. Remove the retaining ring by carefully grasping the handle and pulling inward, then upward. The retaining ring should slide completely out of the groove.
7. Remove the top cap of the system by lifting up on the top handles, remove old filter.
8. Open the John Guest® fitting and shut-off, and flush out the bottom of the system.
9. Look down into the tank assembly, and you should see a small opening centered in the bottom of the tank.
10. Remove packaging from the new filter, place the new cartridge into the tank with the double o'ring facing down.
11. Position the cartridge so that it is aligned with the bottom, center opening.
12. Press down on the cartridge so that the double o'ring seal moves into place within the bottom, center opening.
13. Reposition the Top Cap into its original location.
14. Reattach the top tank Snap Ring, pull up on the Top Cap to seat o-rings.
15. (If completed Step 2, then...) Close the John Guest® fitting and shut-off.
16. Turn the water supply on, opening the inlet and outlet valves on the bypass.
17. Relieve the system of air in the tank as the system fills with water, by pushing down on the red depressurization button on the top cap of the system. Keep the button pushed down until all the air pressure is completely released, and water comes out of the red depressurization button.
18. Release the red depressurization button.
19. Replace the Umbrella cap to the top of the system.
20. Check for leaks.
21. Flush the new cartridge per its installation instructions.
22. During flush, confirm green LED lights are flashing with flowing water. If lights are not flashing green, go back to step 3.

#3 UMBRELLA CAP & LED LIGHTS

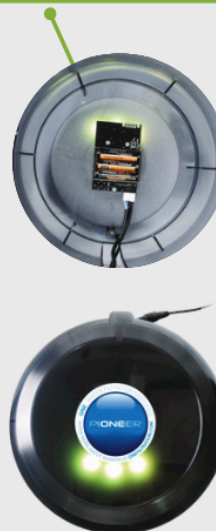

PRESS THE RED PRESSURE RELIEF VALVE & PULL SNAP-RING



LIFT TOP CAP



B). PRE-FILTER CARTRIDGE: Replace every 12 months or when LED on main tank turns Red (whichever comes first). If you notice a significant reduction in water flow before the LEDs turn RED, you'll need to replace the Sediment Pre-Filter sooner.

C). DESCALER-MAX™ CARTRIDGE: Replace every 2 years (regardless of gallons used).

ONCE A MONTH: If you're on CITY WATER, it is recommended to bypass the whole filter system and run regular city water through your plumbing by opening all the faucets (hot & cold) in your home for apx. 5 minutes. This will help periodically sanitize your pipes with chlorinated water.

Note: During cartridge changes, you may wipe the housings down inside with a paper towel to remove any buildup.

KEEP SYSTEM OUT OF DIRECT SUNLIGHT OR FREEZING TEMPERATURES.

Minimum Operating Temperature 34 F / 1 C
Maximum Operating Temperature: 120 F / 50 C
Minimum Operating Pressure: 20 psig / 1.38 bar
Maximum Operating Pressure: 80 psig / 8.6 bar
Electrical Requirements: Grounded & Unswitched 115 V outlet and 3-AAA Batteries
Filter Replacement Operating Instructions: New cartridges must be flushed for a minimum of 10 minutes prior to use. System and installation to comply with state and local laws and regulations.
Do not use with water that is microbiologically unsafe or unknown quality without adequate disinfection before or after the system. Systems certified for cyst reduction may be used on disinfected waters that may contain filterable cysts.
Manufactured from NSF/ANSI standard 61 and California Prop 65 Compliant certified coconut shell carbon and raw materials.

WARNINGS

If this or any other system is installed in a metal (conductive) plumbing system, i.e. copper or galvanized metal, the plastic components of the system will interrupt the continuity of the plumbing system. As a result any errant electricity from improperly grounded appliances downstream or potential galvanic activity in the plumbing system can no longer ground through contiguous metal plumbing. Some homes may have been built in accordance with building codes, which actually encouraged the grounding of electrical appliances through the plumbing system. Consequently, the installation of a bypass consisting of the same material as the existing plumbing, or a grounded "jumper wire" bridging the equipment and reestablishing the contiguous conductive nature of the plumbing system must be installed prior to your systems use.

DO NOT USE extra lubricants, unapproved sealants and tools to tighten hand tightened only parts. Use of tools other than hand tighten only parts voids warranty. Testing was performed under standard laboratory conditions; actual performance may vary. Flush the system and change the filter as suggested. The contaminants or other substances removed or reduced by this water filter are not necessarily in all users' water.

PERFORMANCE

This system conforms to NSF/ANSI 53 for the specific performance claims verified and substantiated by test data. Performance claims are based on independent lab results and manufacturer's internal test data*. Actual performance is dependent on influent water quality, flow rates, system design and applications. Your results may vary. Performance claims are based on a complete system, including a filter, housing, and connection to a pressurized water source. This filter must be operated according to the system's specifications in order to deliver the claimed performance. It is essential to follow operational, maintenance, and filter replacement requirements, as directed for each application, for this filter and system to perform correctly. Read the Manufacturer's Performance Data Sheet accompanying the system and change the filter as suggested. The contaminants or other substances removed or reduced by this water filter are not necessarily in all users' water.

RETURN POLICY & WARRANTY

1. If the filter arrived damaged, please call us immediately to get an exchange: 1-347-492-4014
2. If you choose to return the filter for any reason other than damage upon arrival, we will be happy to issue a full purchase price refund or exchange within: **14 days of delivery date, minus shipping cost. The return policy applies to water filter systems and any unused (sealed) filter media cartridges.** If cartridges have been opened and used, we will deduct the price of the cartridges from the refund, as they will no longer be re-sellable.
3. **If you decide to return past the 14-day return period, we will still accept the item for up to 30 days from delivery date,** however, there will be a reasonable 10% restocking fee applied. Please call us or send an email to initiate the return process or if you have any further questions.

Once you've experienced your new system, feel free to share your positive experience by going to our website product page and writing a review. ☺ Thank You! - The PureEffect Team



NO-HASSLE 2-YEAR WARRANTY

*PureEffectFilters LLC. dba PureEffectFilters.com, warrants its water filter systems to be free of defects in parts and workmanship for a period of: **two (2) years** from the date of purchase. All our systems are made of high-quality components (not made in china) and are designed to last for many years beyond the warranty period, but if any manufacturing defect is present, it will make itself know well within the warranty period.*

*In the rare case that it should become necessary to repair or replace the filtration system or one of its components, please take a photo of the damaged part and email it along with your order # and a detailed description of the defect to: **info@PureEffectFilters.com** or contact our Customer Service Department at: **1-888-891-4821**. We will handle your claim promptly, and as hassle-free as possible.*

This warranty does not apply to defects resulting from action/s of the user such as: misuse, accidents, improper installation, operation outside of specification (e.g. over the indicated PSI limit, exposure to direct sunlight, freezing temps, UV light), improper maintenance or repair and unauthorized modification.

PureEffectFilters LLC total liability is limited solely to repair or replacement of the product. The warranty set forth above is inclusive and no other warranty, whether written or oral, is expressed or implied.